



F2 XTREM[®]

Helmet

MSA GALLET

[Multi-functional Helmet]



Retaining the advantages of its predecessor called the F2, the F2^XTREM helmet version "Forest Fires" has maintained all the assets of a helmet designed for forest fire fighting. The F2^XTREM is well ventilated, fire proof, lightweight for more comfort, and effective under action, responding to the customer needs under the most extreme and dangerous conditions when exposed to fire.

GA33xx

Standard: EN 12492,
EN 443 [Only for flame resistance]

Possible colours: red, black, photolum, white, blue,
yellow, grey, orange.

Helmet characteristics: Ratchet, vented shell

Sizes: 52 – 64 cm

Weight: 820 g [± 30 g]

Recommended accessories
[to be ordered apart]:

Goggles: colour black or orange

Stickers: colour silver, orange, yellow, blue or green

Options:

Lamp XP, neckcurtain, hearing protection, visors,...
[see list back page]

[Forest Fires]



Side ventilation system

The F2^XTREM helmet version EN 12492, preserving the ventilation system and equipped with a special three point chin strap, is adapted to practically all rescue situations in a hazardous environment. Whether you are in an emergency station on a mountain or intervening following a natural catastrophe, your F2^XTREM helmet will provide you with ensured protection, while letting you forget about it on your head thanks to the lightweight and ergonomic design.

You will be equally protected from falling rocks, shocks, untimely fits of dizziness, while preserving a real mobility in hostile, confined, hazardous or congested environments.

GA33xx

Standard: EN 12492

Possible colours: red, black, photolum, white, blue,
yellow, grey, orange

Helmet characteristics: Ratchet, vented shell

Sizes: 52 – 64 cm

Weight: 650 g [± 30 g]

Options:

Retro reflective stickers: colour silver, orange, yellow,
blue or green

Lamp XP, neckcurtain, hearing protection, visors,...
[see list back page]



[Climbing and Natural Catastrophes]



[Traffic Rescue]

Rear-view reflector signalings



Many professions are called on to intervene during a traffic accident: firefighters, ambulances, paramedics [samu], doctors or police forces, each having their emergency/assistance role to play. The F2XTREM helmet, combining protection, comfort, mobility and a stylish design, can respond to every function involved in the application of such an emergency/relief operation: it is easy to don thanks to a rapid adjustment system [ratchet]; it can be used while driving; it can be viewed from far off thanks to its retro-reflective stickers; it is compact for all kind of handling operations and victim manipulations. Protect yourself when rescuing somebody else!

GA35xx

Standard: CE Marking, EN 12492 [except ventilation], EN 443 [Only for flame resistance], EN 397/A1 [Only for electrical isolation]

Possible colours: red, black, photolum, white, blue, yellow, grey, orange

Helmet characteristics: Ratchet, not vented shell

Sizes: 52 – 64 cm

Weight: 650 g [± 30 g]

Options:

Retro reflective stickers: colour silver, orange, yellow, blue or green

Neckcurtain, hearing protection, visors,...
[see list back page]

TREM®



One of the main evolutionary changes in the F2XTREM helmet resides in a new function: respond to new needs in individual protection on an industrial site, whether ensuring protection in a chemical environment, protection against shocks, protection for work performed at heights or on high voltage cabling and lines. This version of the F2XTREM helmet responds to the EN 397 standard. In this version, the helmet is non vented at the top of the head. Its comfort is based on a ratchet system, allowing it to be rapidly adjusted and at any moment on the wearers head.

GA32xx

Standard: EN 397

Possible colours: white

Helmet characteristics: Ratchet, not vented shell, no chintrap

Sizes: 52 – 64 cm

Weight: 570 g [± 30 g]

Options:

2 points chintrap, neckcurtain, hearing protection, visors,...
[see list back page]

Ratchet system



Optional chin strap



[Industrial Risks]



[The helmet for all Extremes]

The new F2 X TREM helmet is available in several versions and thus responds to all extreme applications.

The new quick adjust system of this product, called the Ratchet System, reinforces the multifunctionality of the helmet without compromising comfort.



Forest fires: Endowed with tinted lens goggles, retro reflective stickers and perfectly vented: the most suitable helmet for forest fire-fighting.



Traffic: Not vented, not necessarily with goggles and in a color of the wearer's choice, this helmet corresponds perfectly to the multiple risky situations on roads and highways.

Rescue work in hazardous environments: The same vented helmet, not necessarily with retro-reflective stickers, according to needs, is certified according to the EN 12492 alpinist standard to operate in rescue situations in a hazardous environment.

Industrial risks: Non vented, and dielectric insulated, the F2 X TREM helmet responds to the EN 397 standard and can be used in all industrial environments to protect against shock and sharp falling objects, as well as against chemical risks.





GA 32xx
EN 397
Industrial risks version

GA 33xx
EN 12492
Climbing and natural
catastrophes version

GA 34xx
NIT 312
GA 33xx
EN 12492
Forest Fire version

GA 35xx
CE marking
Traffic rescue version

[Options]

- 1 **GA3007NA** Black goggles transparent lens
GA3007OB Orange goggles tinted lens
- 2 **GA1457** Lamp XP [only for GA33xx and GA34xx]
GA1426 Lamp support
GA3230* Retro-reflective stickers
*Available colours: B0 = Silver, R0 = Red, J0 = Yellow, T0 = Blue, V0 = Green
- GA1616** klar-pilot screen cleaner
Face piece with F2 X-TREM adapters
[please see leaflet 05-405.2 GB]
- GA3240** Neckcurtain for F2 X-TREM

[Accessories]

- 3 **SOR60040** Colorless polycarbonate visor, 20 cm
SOR60041 Colorless polycarbonate visor, 16 cm
SOR60042 Colorless polycarbonate visor, 10 cm
- 4 **SOR60060** Metal mesh for Forest Work
SOR60065 Nylon mesh for Forest Work
SOR60020 Visor holder
SOR60012 Visor fastener [x 2]
- 5 **SOR12015** Passive ear muff X-TREM
SOR12012 Passive ear muff, HPE, SNR 31 dB
SOR36602 Passive ear muff, FM Pro
- 6 **T1900700** Nomex neck protection
T1900300 PVC neck protection
- 7 **B0258213** 2 point chin strap for GA32xx version
- 8 **GA10xxx** Communication Systems L'COM, OSTEO or MICRO
[please see leaflet 36-304.2 GB]

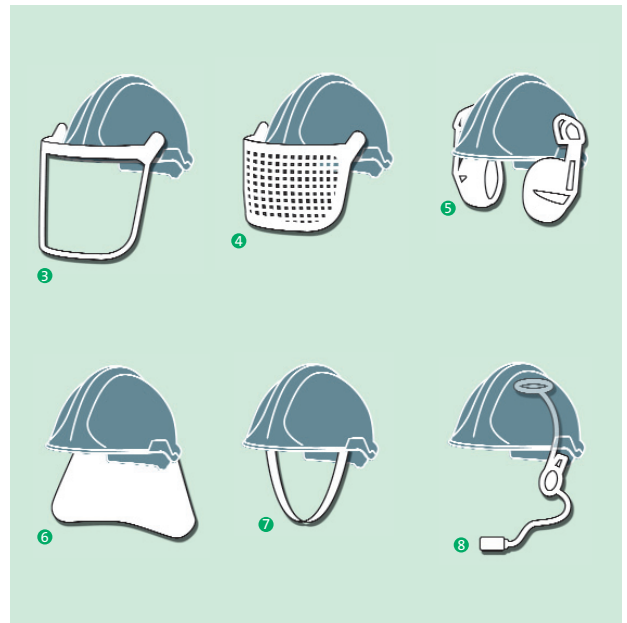
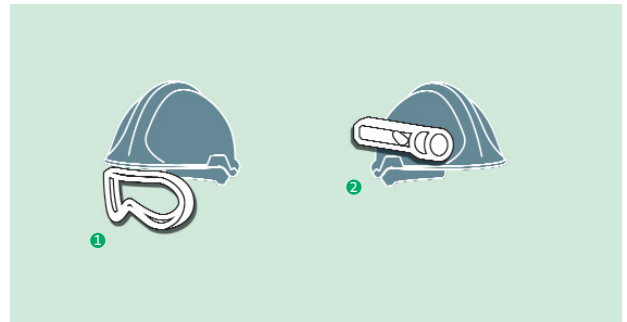

MSA GALLET
BP 90, Z.I. Sud
01400 Châtillon sur Chalaronne
FRANCE
Phone: +33 [0] 474-55 01 55
Fax: +33 [0] 474-55 47 99
E-mail: message@msa-gallet.fr
http://www.msa-gallet.fr

Central Europe
MSA AUER GmbH
Thiemannstrasse 1, D-12059 Berlin
Phone: +49 [30] 68 86-0
Fax: +49 [30] 68 86-15 17
E-mail: info@auer.de
http://www.msa-europe.com

Eastern Europe
MSA AUER GmbH
Thiemannstrasse 1, D-12059 Berlin
Phone: +49 [30] 68 86-25 99
Fax: +49 [30] 68 86-15 77
E-mail: mee@auer.de
http://www.msa-europe.com

Northern Europe
MSA Nederland B.V.
Kernweg 20, NL-1627 LH Hoorn
Phone: +31 [229] 25 03 03
Fax: +31 [229] 21 13 40
E-mail: info@msaned.nl
http://www.msa-europe.com

Southern Europe
MSA Italiana S.p.A.
Via Po 13/17 - I-20089 Rozzano [MI]
Phone: +39 [02] 89 217-1
Fax: +39 [02] 8 25 92 28
E-mail: info-italy@msa-europe.com
http://www.msa-europe.com

International sales
MSA Europe
Thiemannstrasse 1, D-12059 Berlin
Phone: +49 [30] 68 86-555
Fax: +49 [30] 68 86-15 17
E-mail: contact@msa-europe.com
http://www.msa-europe.com

MSA GALLET